

Installation Manual

Full Upgrades Bundle Kits for: Maxx
Model Hop-up Chamber (all New Gen)



Installation Manual

True Centering Unit (TCU) for: Maxx
Model Rotary Chamber (New Gen. All)

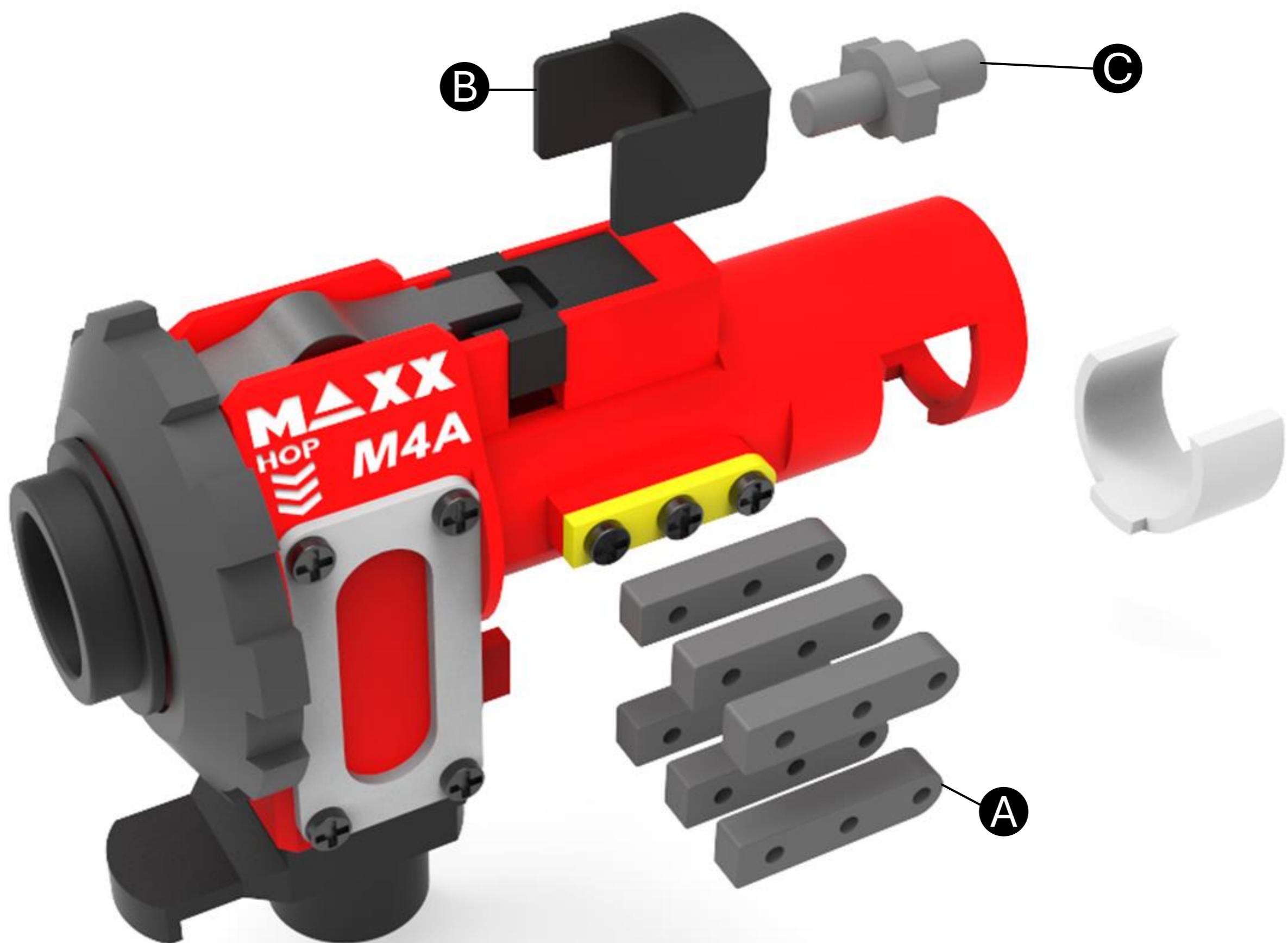

What is included?

- A. Various Sized Side-Wings
- B. TCU True Centering Unit
- C. TCU Lock

A1. There are 3x sets of side-wings with various widths that are to be replaced the current original brass side-wings by Maxx Model. You can identify the width size by looking at the side of the wing where this info is engraved.

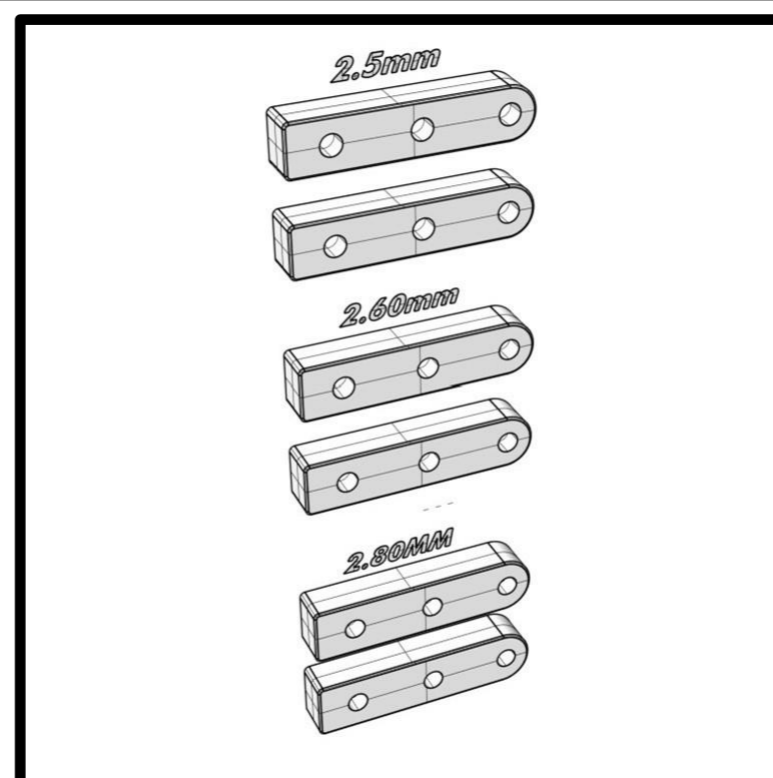

A1

A2. The original brass side wings are locked at both side of the Maxx Model New Gen Chamber. Both of these will need to be removed.

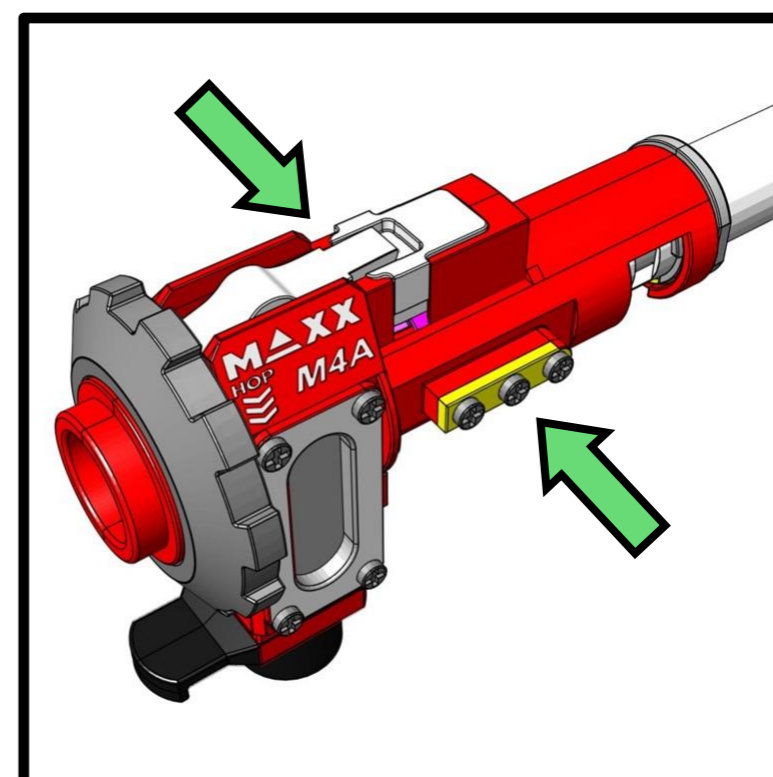

A2

A3. Unscrew the mini screws and remove the side-wings. You need approx. a micro M1.5 screwdriver. Once its off, keep the screws as you will need reuse them for the upgraded version.

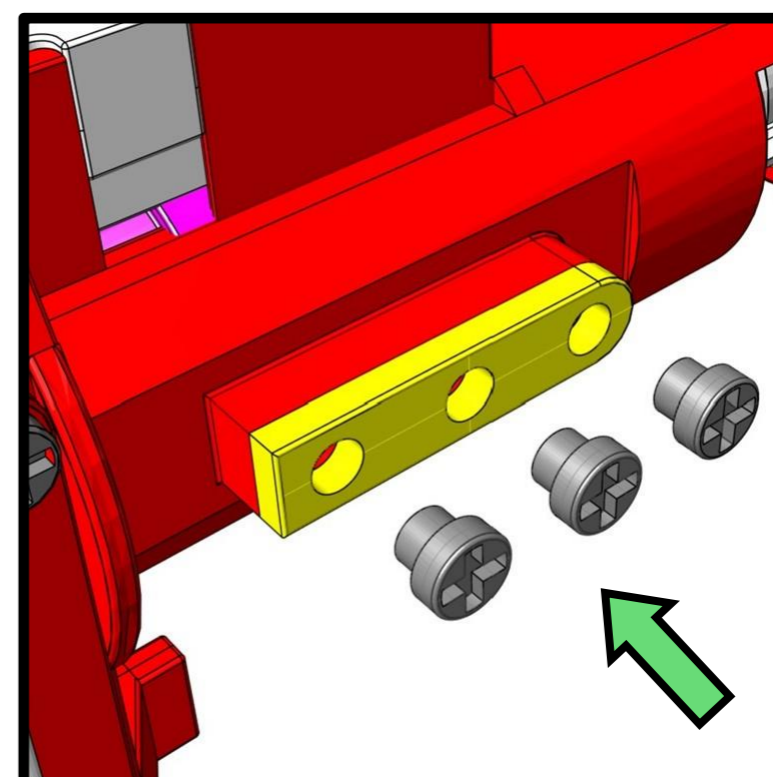

A3

A4. Remove the outer barrel from the upper receiver. There should be some screws first to remove the handguard and another holding the outer barrel. Once it's out it should look like the Demo pic to the right.

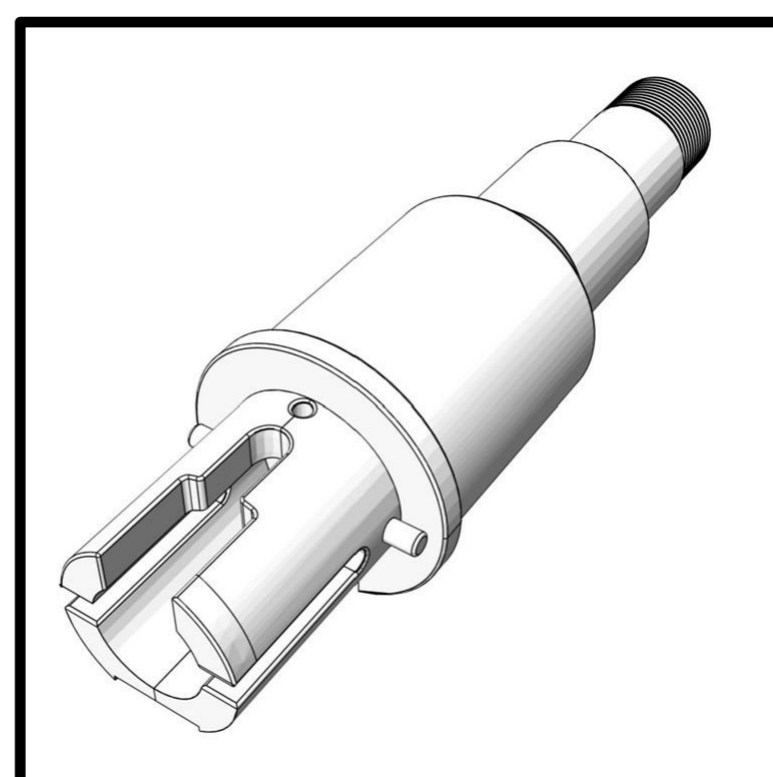

A4

A5. First This step is to determine which side wing has the best fitting on the outer barrel. Different brands and models have different cuttings with minute variances so it's important to test.

Work your way up with the 2.5mm side wing first, 2.6mm and then lastly 2.8mm. You will want the one that's is snug with hardly no movement left, right and center. Too loose or too tight will not be good.

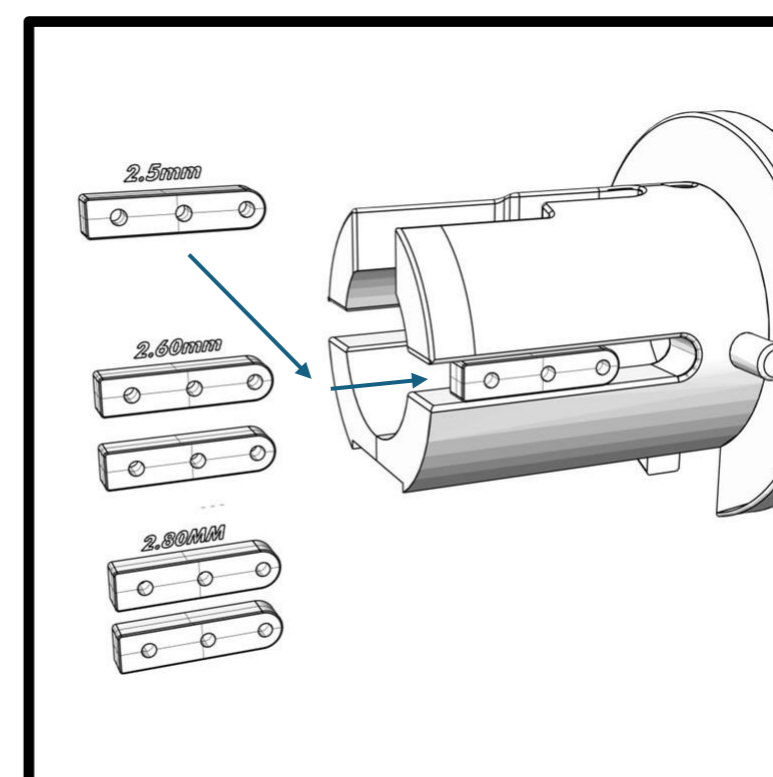

A5

A6. Once you have determined the best side wing for your particular outer barrel/ Gun, take the screws and bolt them back into the Maxx model chamber on BOTH sides.

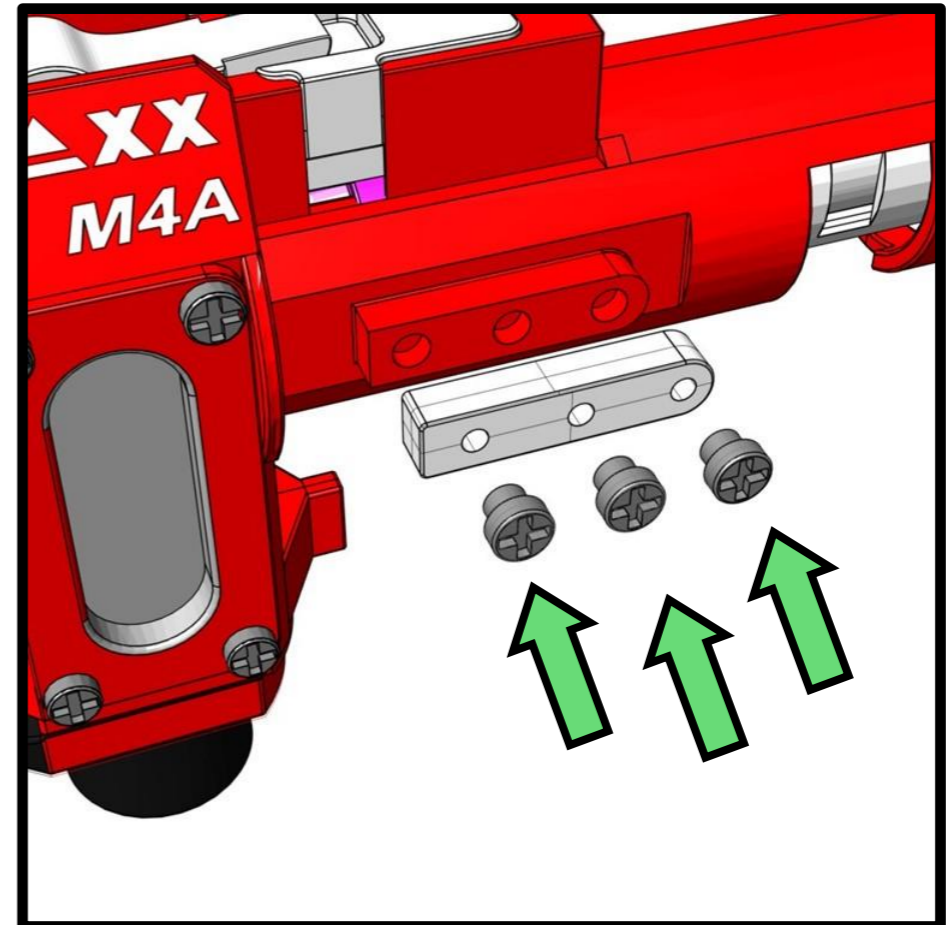

A6

A7. Once the new side wings are installed, try fitting the whole chamber back into the outer barrel.

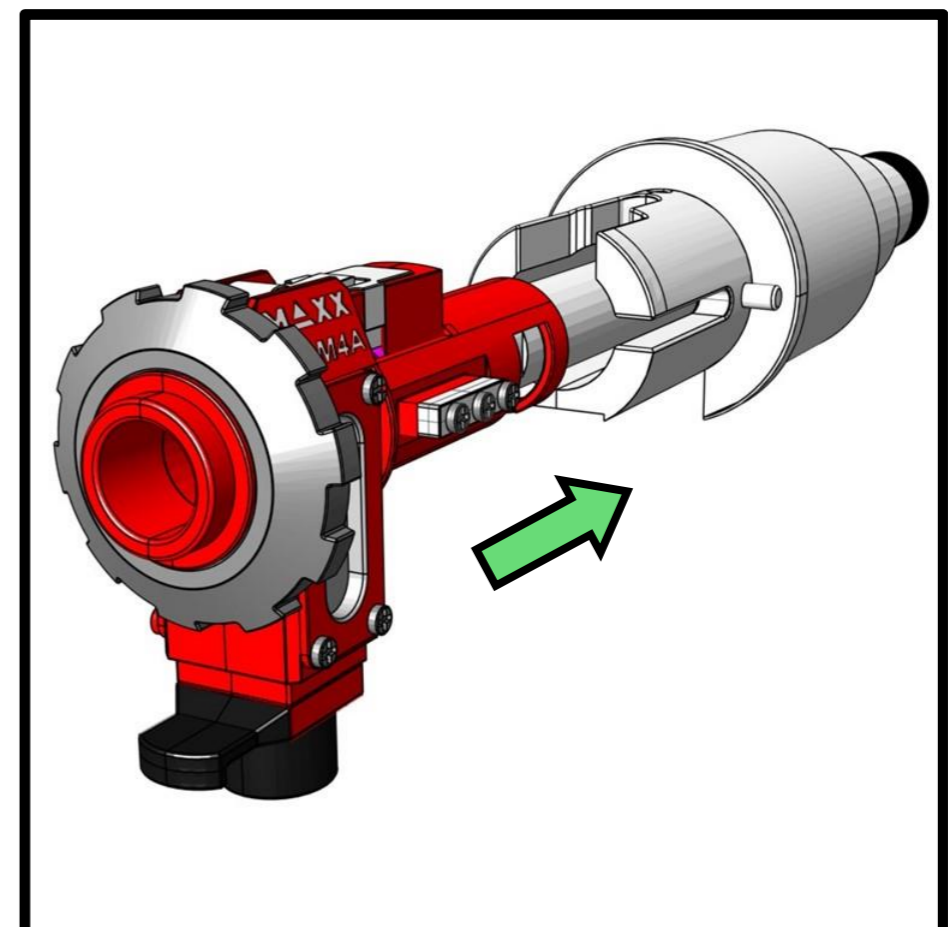

A7

A8. The Maxx chamber with the new side-wings should be able to slide horizontally with ease without much vibration or abrasiveness. We recommend to apply some silicone grease on to the top and bottom of the side-wings to ensure movement goes smoothly.

Take the Maxx Chamber out and move to PART B of Installing the TCU True Centering Unit -

If you feel this is sufficient for you setup and build already as it's enough stabilization, then assemble your gun back together and install the Maxx Chamber.

If you want that EXTRA stabilization, then more to PART B that may require some sanding to the TCU or outer barrel.

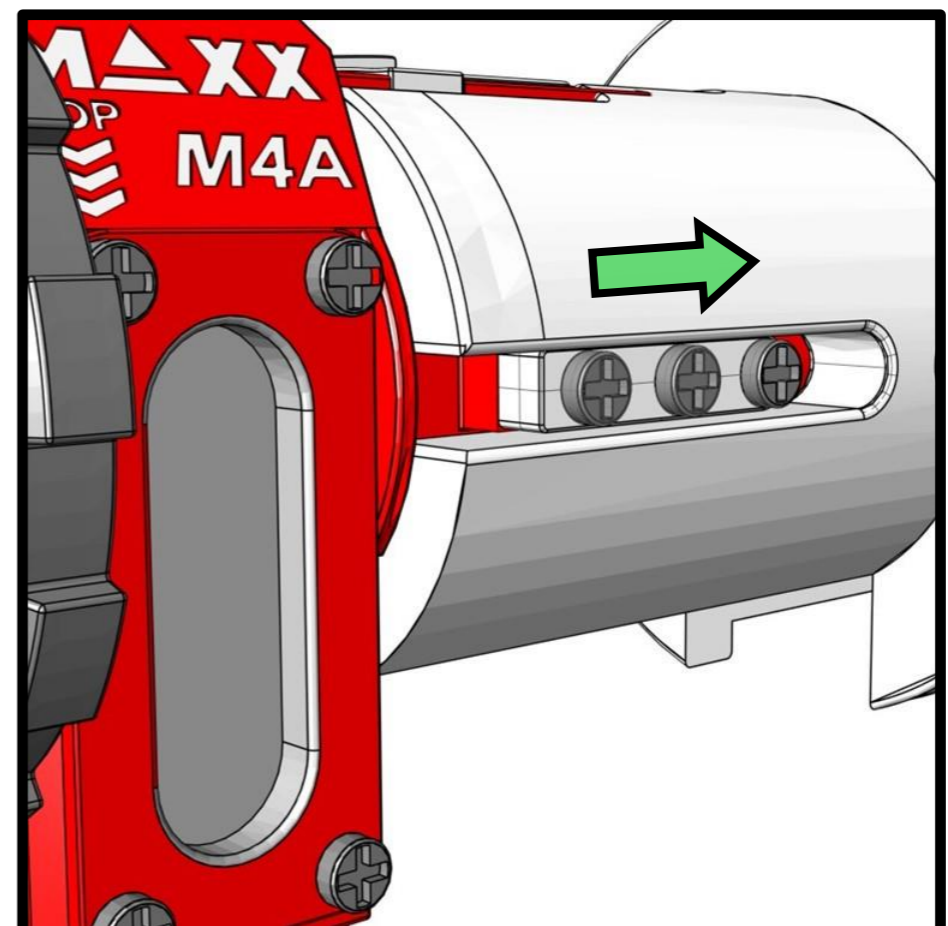

A8

B1. Align Located the TCU unit, Locking pin and Spring from the set.

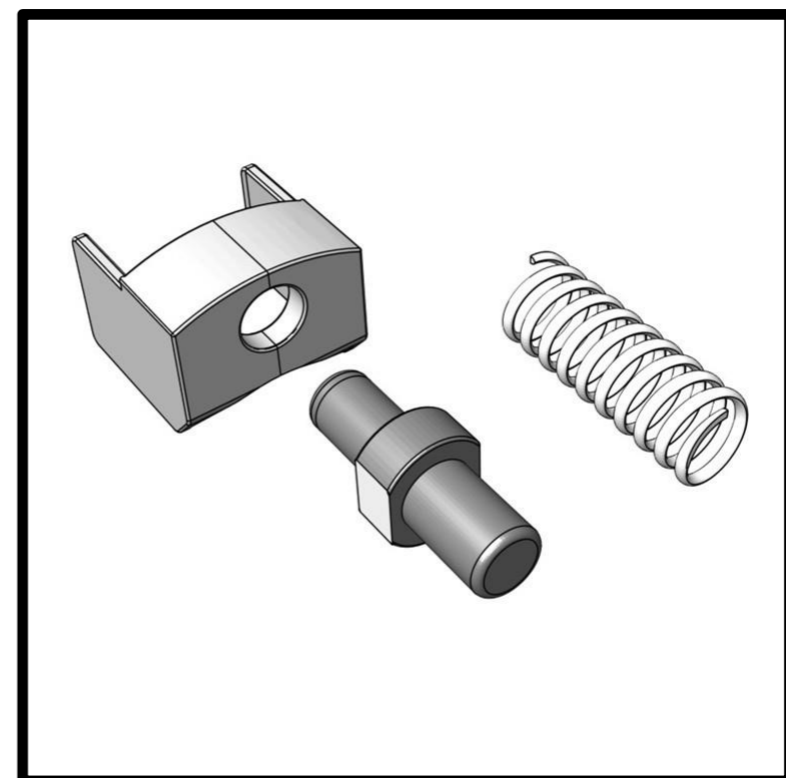

B1

B2. Remove the original metal pin and spring from the Maxx Chamber

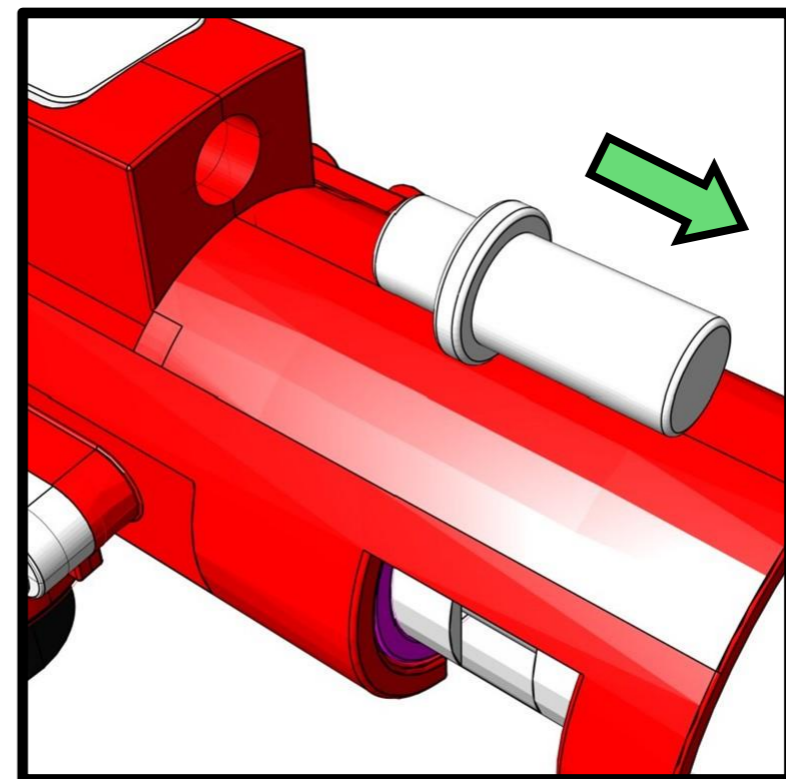

B2

B3. Install the TCU True Centering Unit into the Maxx Chamber.

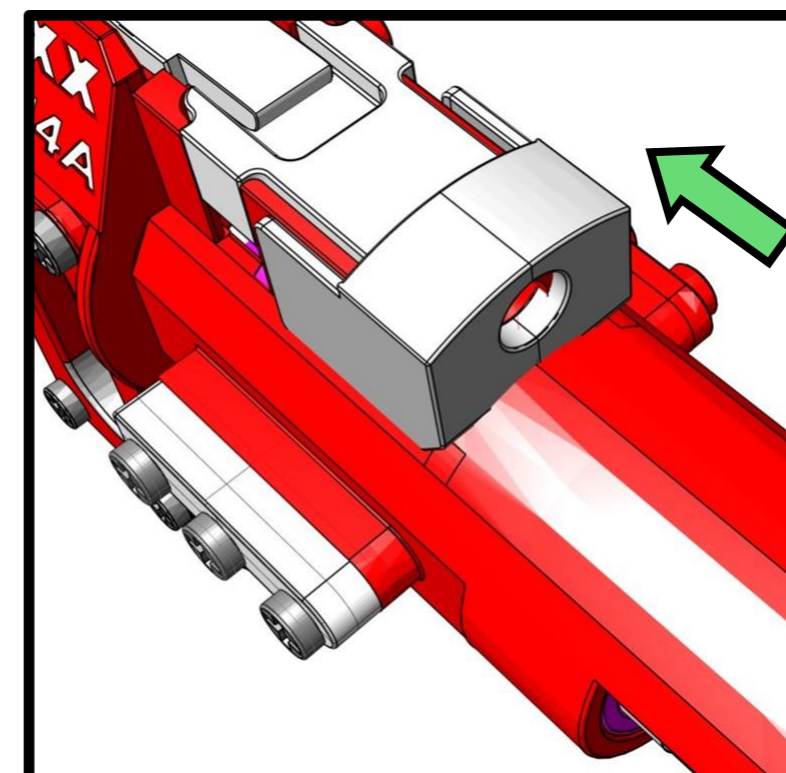

B3

B4. Install the provided spring into the thicker part of the locking unit.

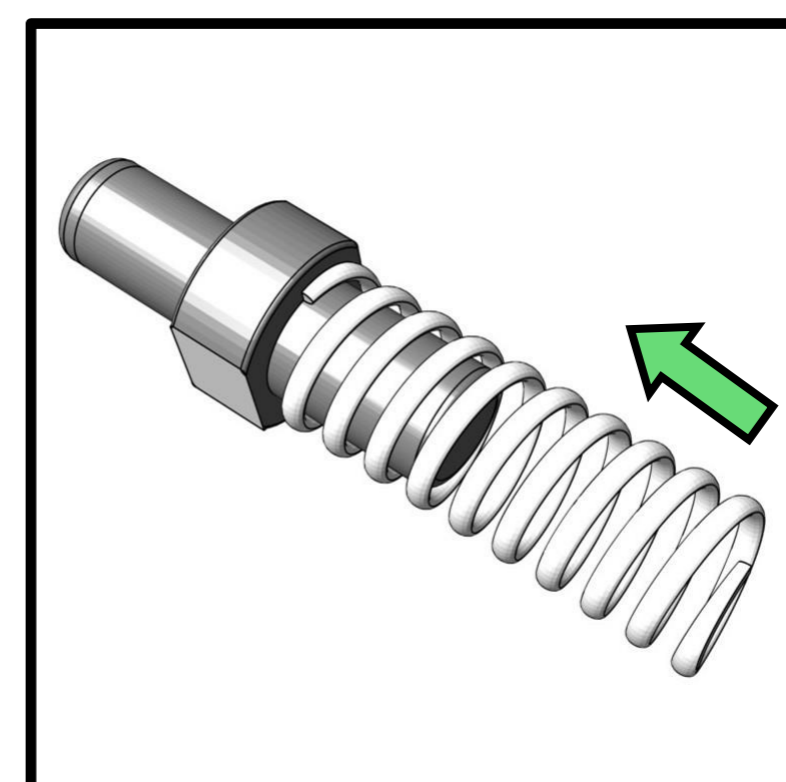

B4

B5. Insert the locking unit with screw into the TCU and into the Maxx Chamber It should b a snug fit. Put some silicone grease if it's too loose.

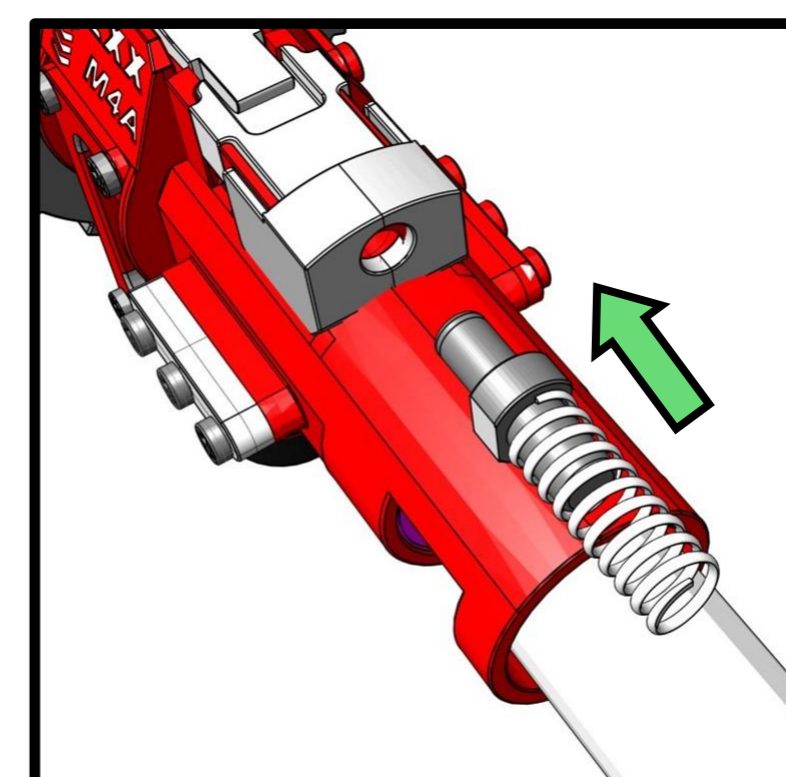

B5

B6. Attempt to insert the Maxx Chamber into the outer barrel. In most cases the TCU should fit into the outer barrel correctly and no modification will be required.

However, depending on the brand and model of the outer barrel you have to sand slightly or modify for the TCU to achieve a perfect fit. See below for the scenario that to your case.

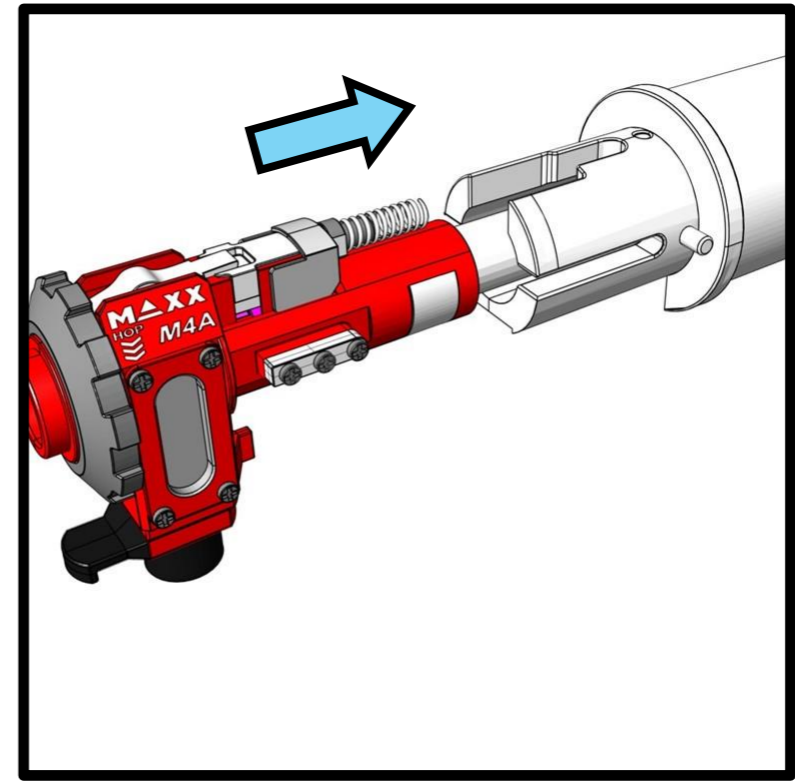

B6

B7. SCENARIO (A) – The TCU with the Maxx Chamber slides perfectly into place. No modification will be required and you can safely assemble all the parts together to complete the installation process.

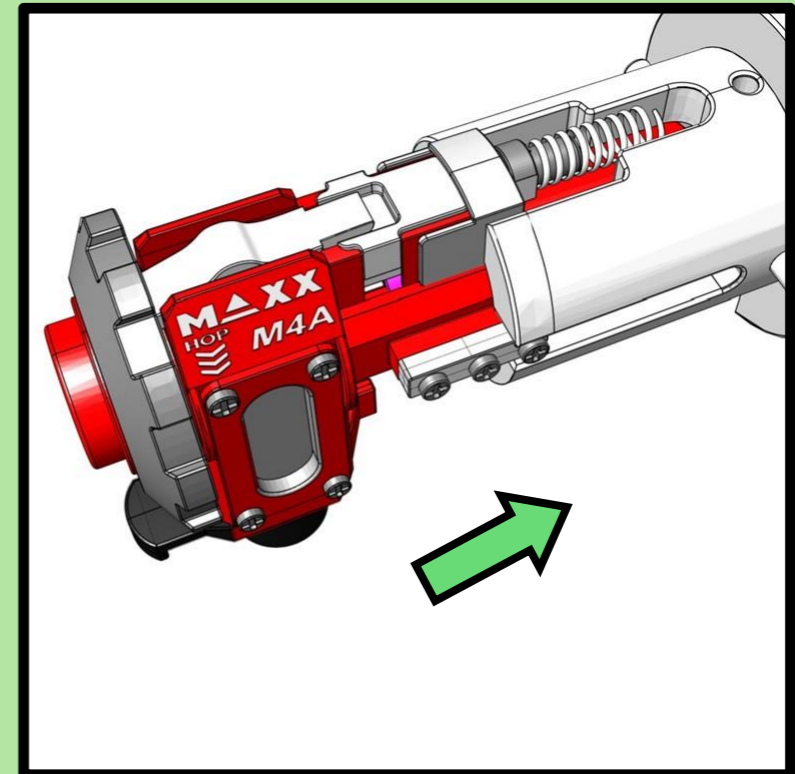

B7

B8. SCENARIO (B) – As shown in the demonstration, each side of the TCU is blocked by the edge of the outer barrel **SLIGHTLY**. In this case you can sand the TCU on each side lightly and incrementally until it fits perfectly into the outer barrel.

Alternatively you can do the opposite and sand the walls of the outer barrel and do it incrementally until the TCU with Maxx Chamber can slide in easily without resistance.

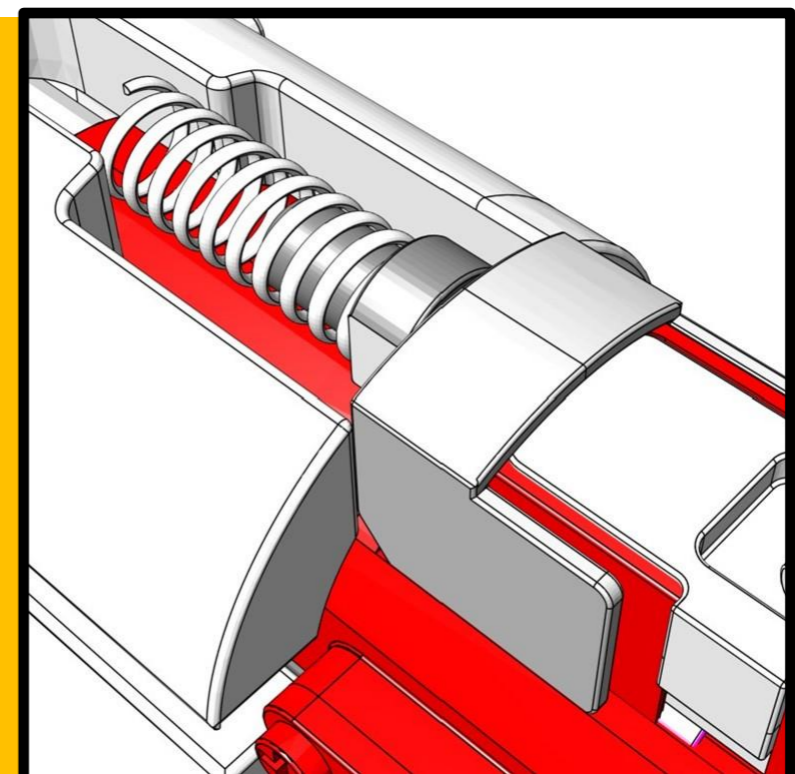

B8

B9 SCENARIO (C) – This is for a more serious case. If the outer barrel heavily blocks the TCU on both sides, then part of the inner barrel will be required for be sanded/ Cut away.

In B10 is the highlighted in **GREEN** of the walls that are blocking the way of the TCU. Mark it with a marker and use sanding tool to sand it down to size. This needs to be precise

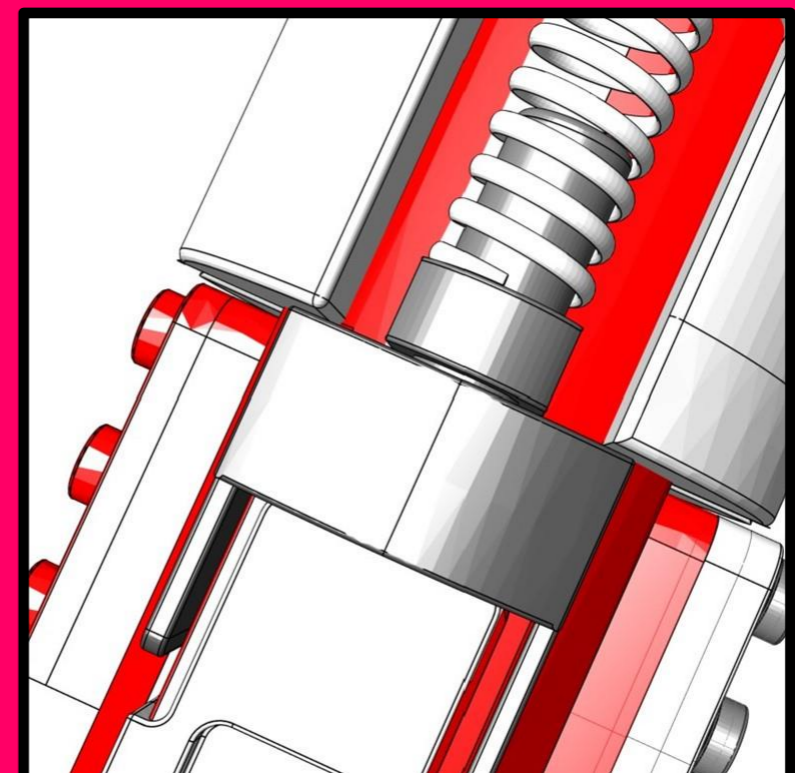

B9

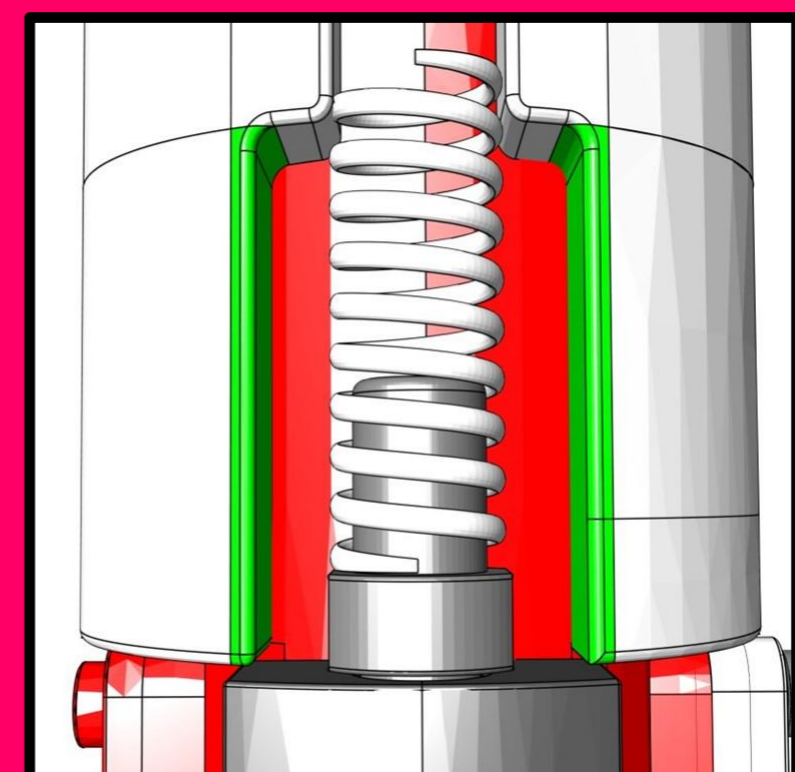

B10

B11. After the TCU is installed successfully both the top and sides of the Maxx chamber will be fully stabilized for the most perfect shot to shot setup.

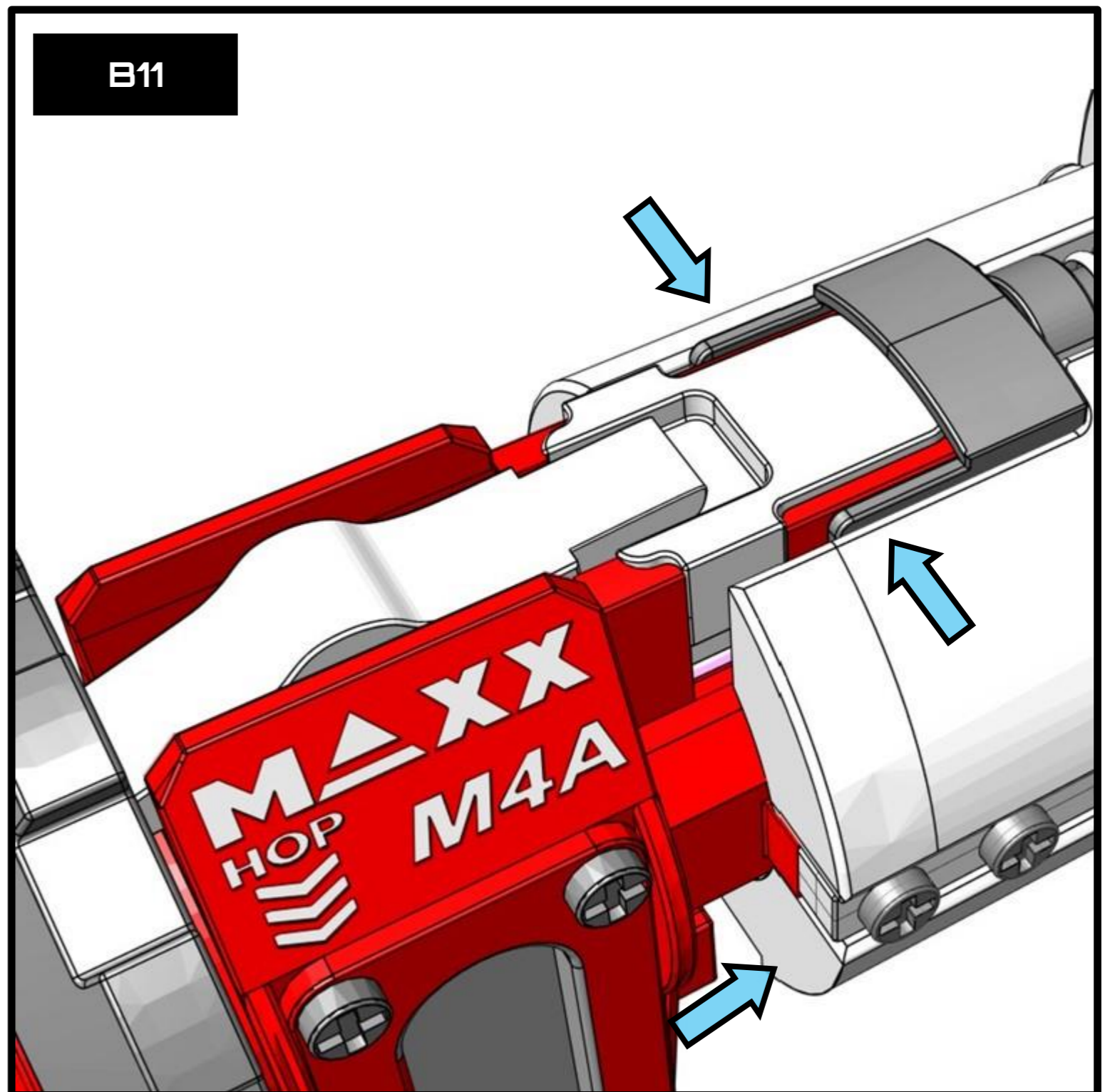

Great job installing the TCU True Centering Unit for your Maxx Model hop-up chamber! With this upgrade, the chamber is now perfectly aligned horizontally, ensuring the most consistent and reliable shots. You won't have to worry about external factors like movement or vibration affecting your performance anymore.

If you run into any issues during the setup process, please don't hesitate to reach out to our technical support team using the email provided. We're here to help you get your Maxx Model dialed in just right. Be sure to provide as much detail as possible about any problems you're facing, and we'll work with you to get everything sorted out.

Let me know if you have any other questions!
info@airtechstudios.com

Airtech Team

Installation Manual

Advanced Inner Barrel Stabilizing O-Ring
for: Maxx Model Rotary Chamber (New Gen.
All)



The Advanced Inner Barrel Ring is designed to provide a secure, centered fit for your hop-up unit. By gripping more of the inner barrel, this component ensures the entire system is firmly in place and properly aligned.

Once installed, you can expect improved consistency and accuracy, especially at longer ranges. After all, in the world of airsoft, any moving parts need to be locked down tightly to maintain peak performance.

If you run into any issues during the setup process, don't hesitate to reach out to our technical support team using the provided email. We're here to help you dial in your Maxx Model just right. Be sure to give us as many details as possible about any problems you're facing, and we'll work with you to get everything sorted out.

Let me know if you have any other questions!
info@airtechstudios.com

C1. Remove the original Brass Ring from the chamber.

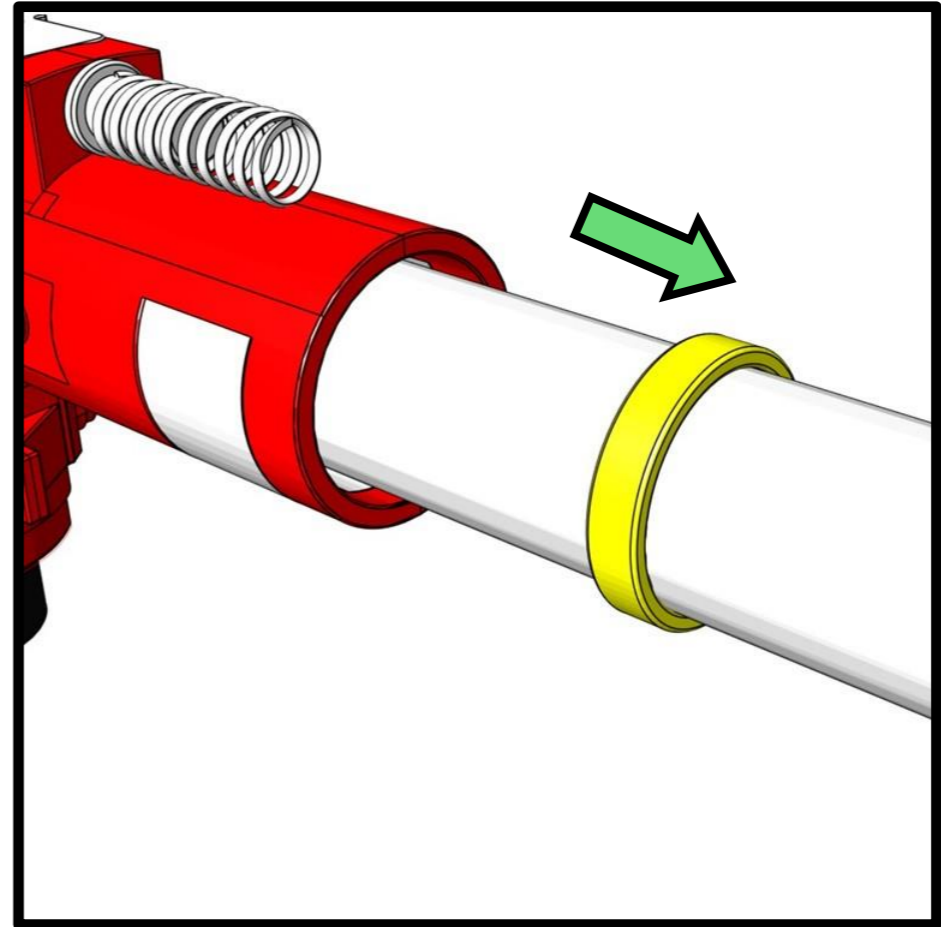

C1

C2. Take the Airtech Advanced Ring and slide it into the inner barrel. It should be a snug fit, however if you find it difficult to slide, slightly sand the inside of the ring incrementally until it slides nicely on the inner barrel.

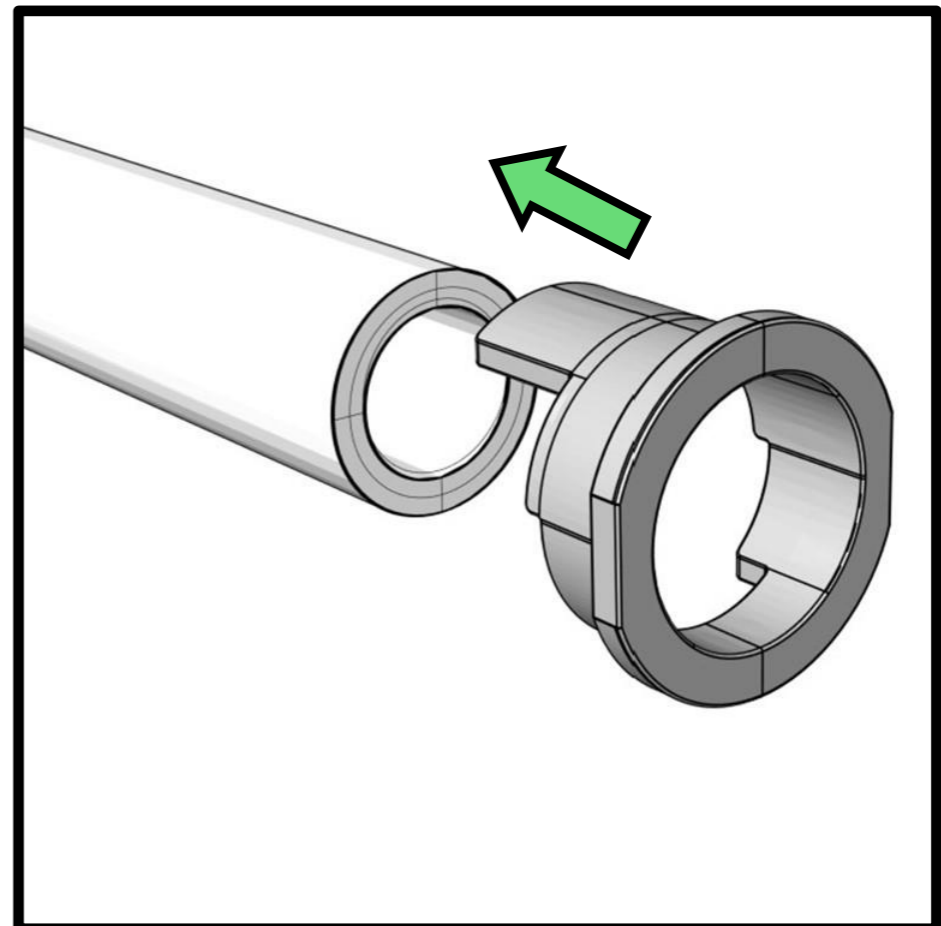

C2

C3. Align the Advanced ring with the elongated parts at the top and push it into the Maxx chamber.

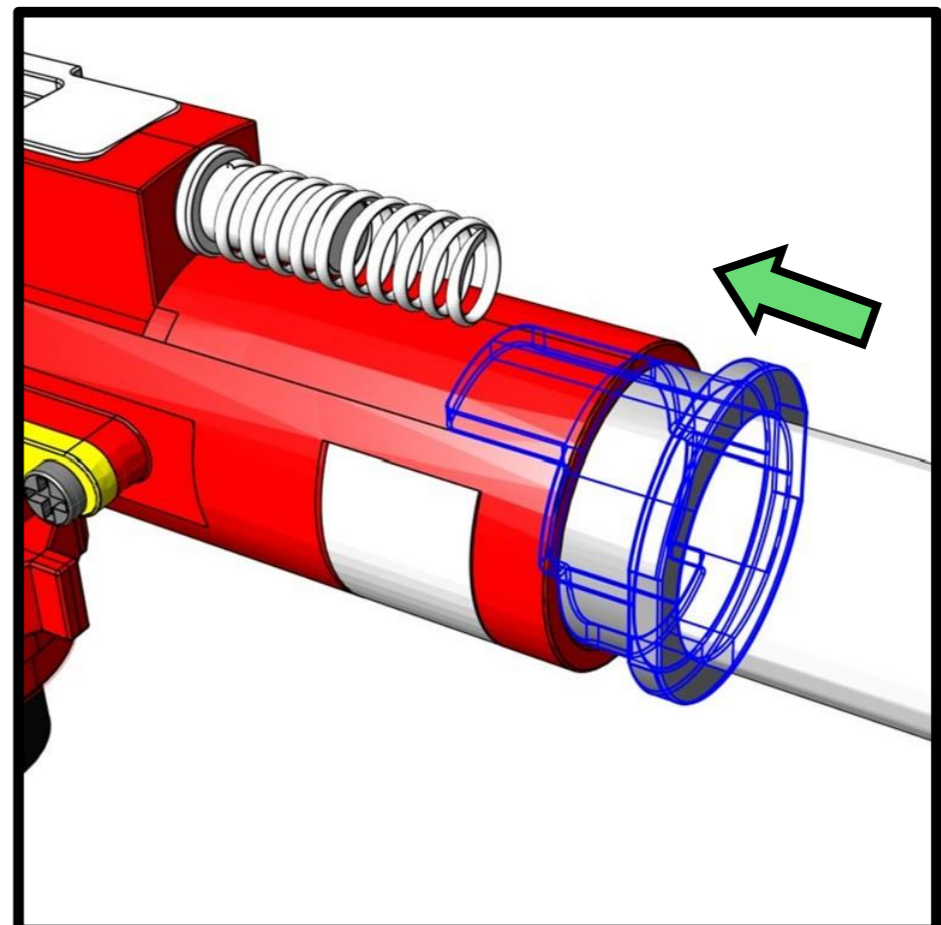

C3

C4. The black silicone rings are included too. Start sliding it into the inner barrel starting with 3x rings.

Next place the Maxx Chamber back and assemble everything back together. If the hop up chamber is loose, take it back out and add another ring. Repeat this until a snug fit is achieved.

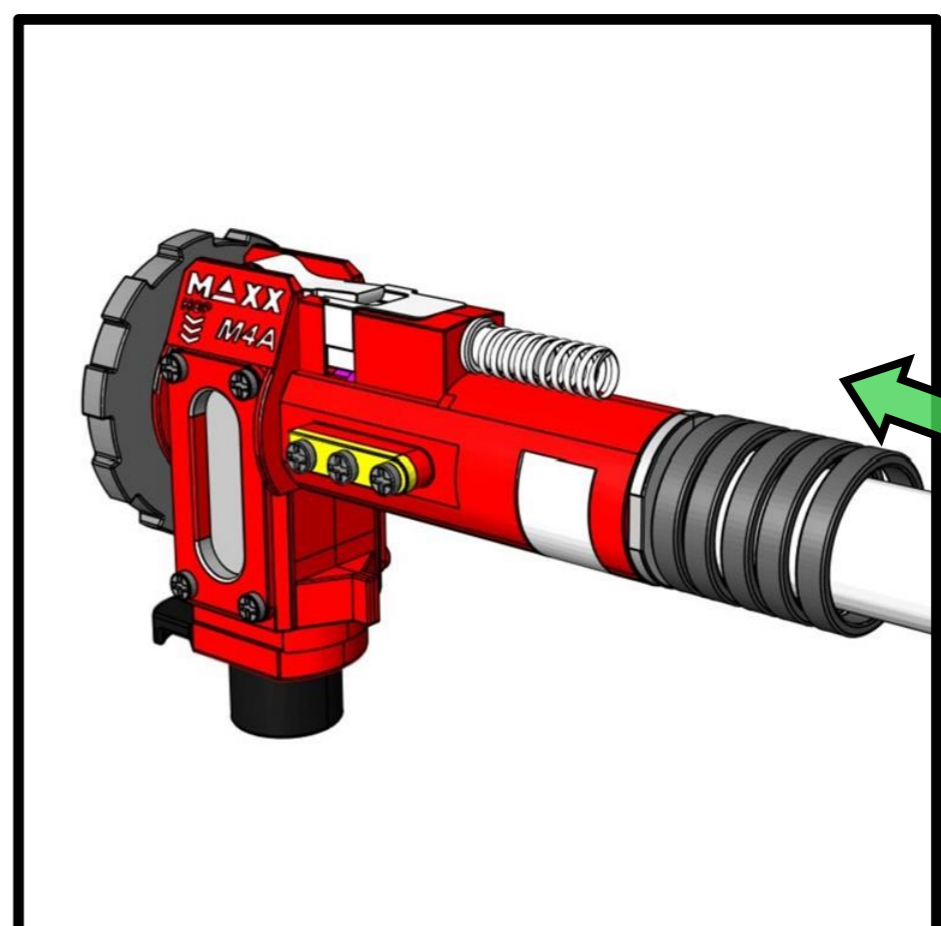

C4

Installation Manual

Advanced Inner Barrel Stabilizing O-Ring
for: Maxx Model Rotary Chamber (New Gen.
All)

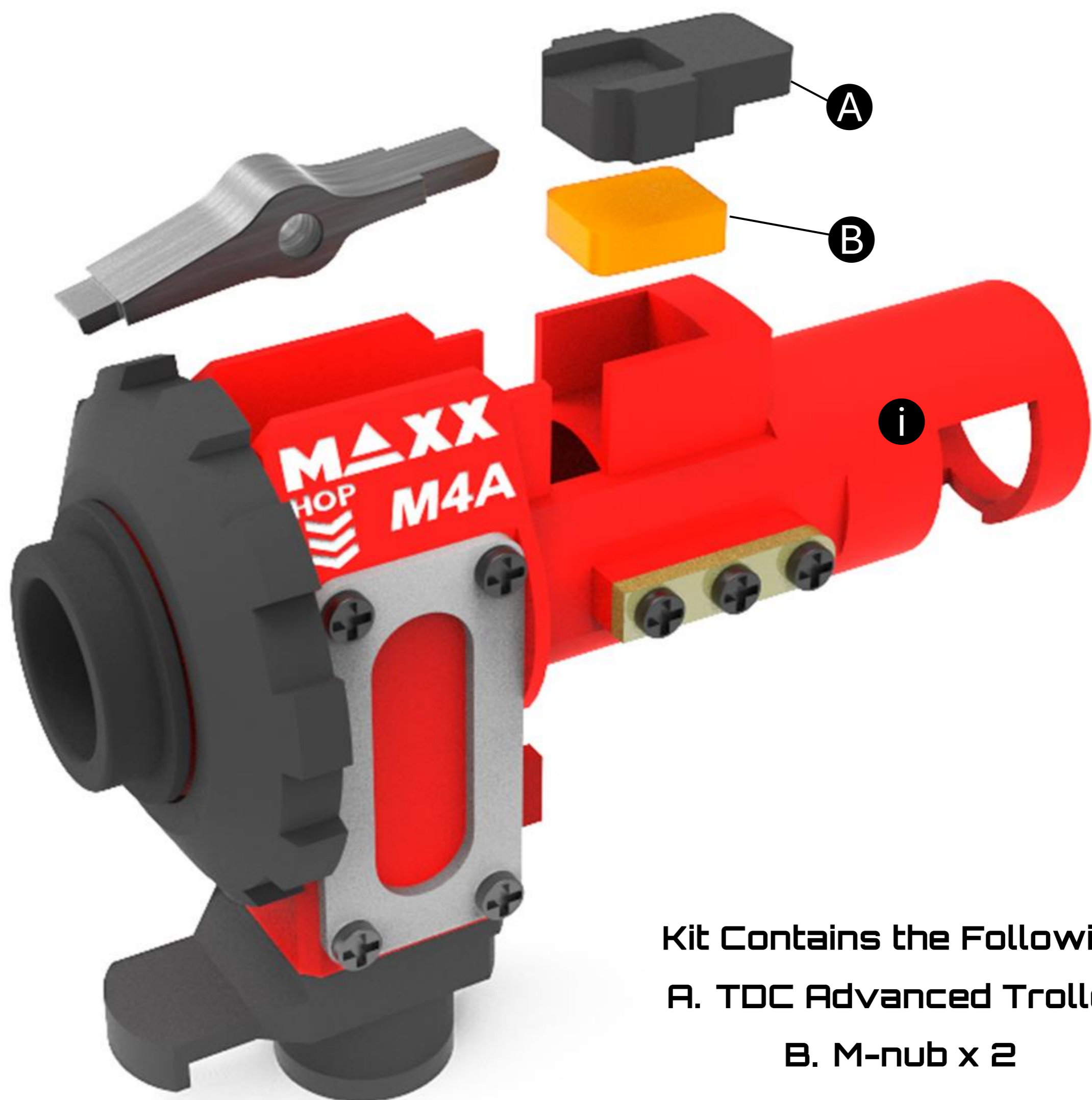

Kit Contains the Following
A. TDC Advanced Trolley
B. M-nub x 2

D1

D1. Install the RHOP patch into the Inner barrel. Some reputable brands includes Psionic, Elvish and Silent Sniper that are good for performance and offers many sizes for different barrel brands and models.

Alternatively, at this stage you can install a RHOP bucking. Brands like Tru-hop and Maple Leaf Macaron are recommended.

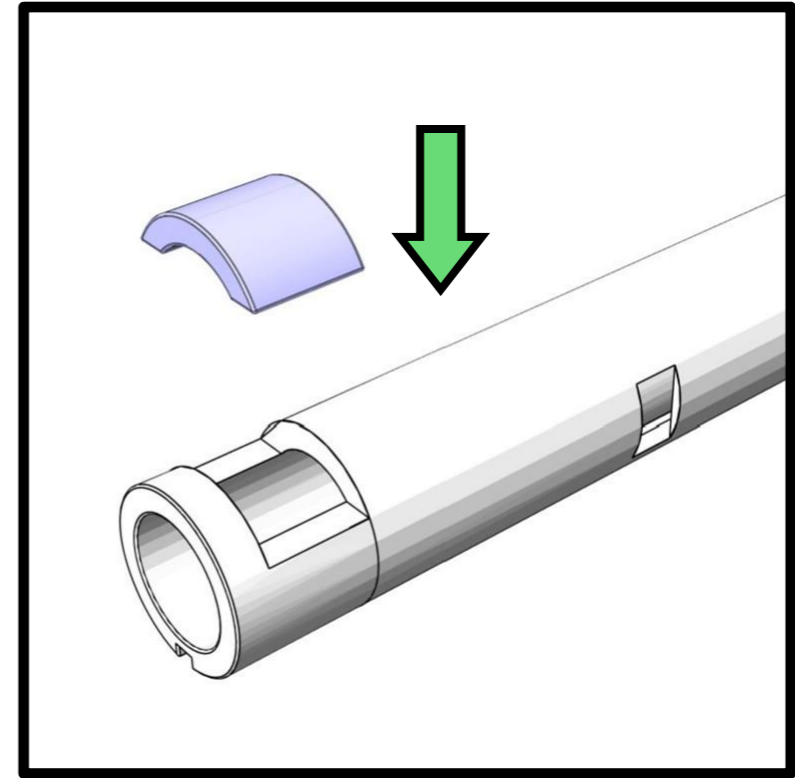

D2

D2. Insert the bucking – ensure this is a mound less bucking. Brands like Prometheus and Modify offers such buckings.

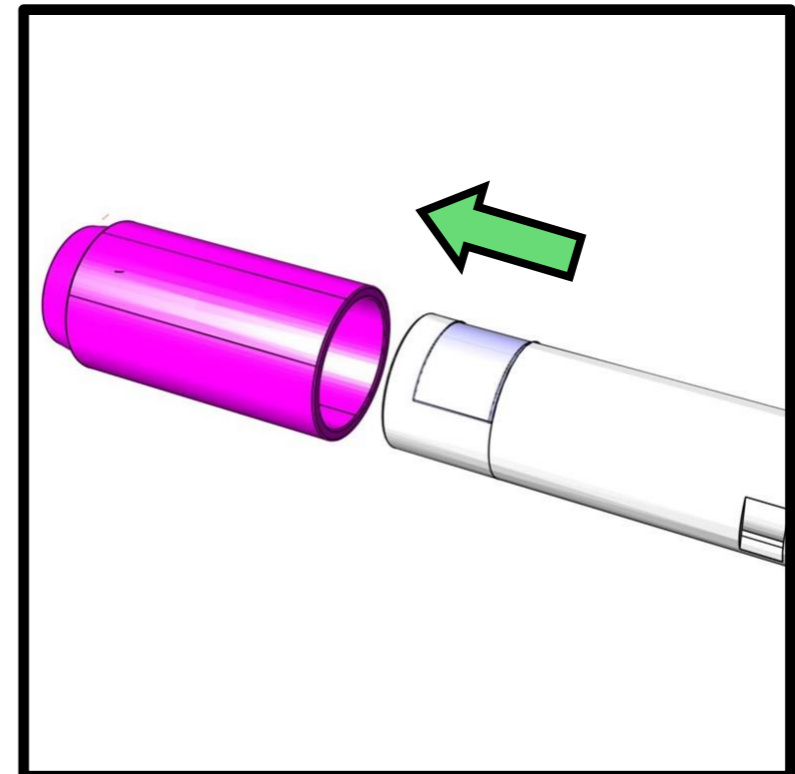

D3

D3. Insert the barrel set up in the Maxx Model hop-up chamber. Apply some silicone grease on around the bucking so it can slide in easily.

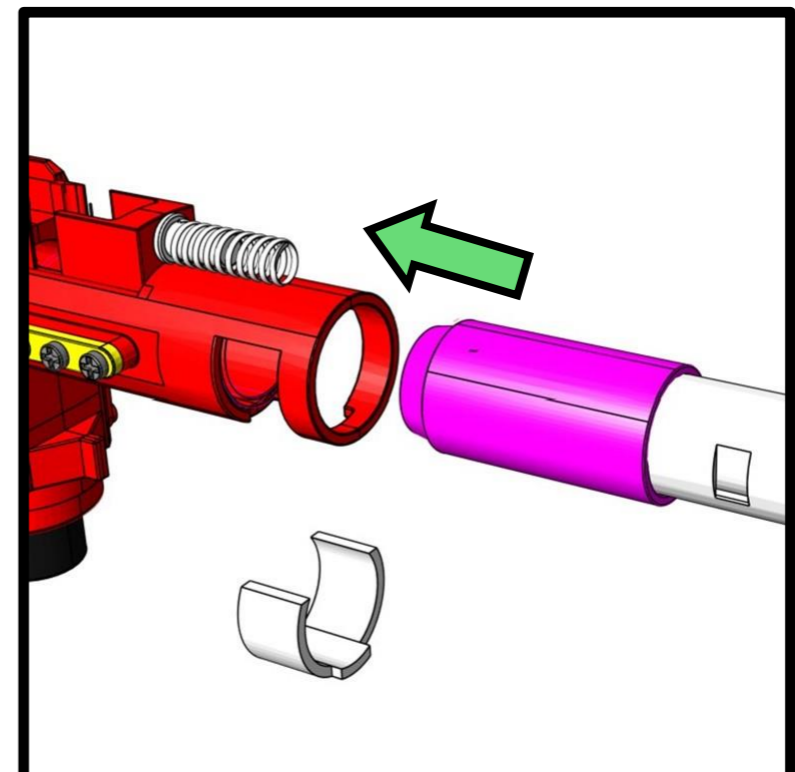

D4

D4. Install the Maxx C-clip. This will keep your inner barrel centered.

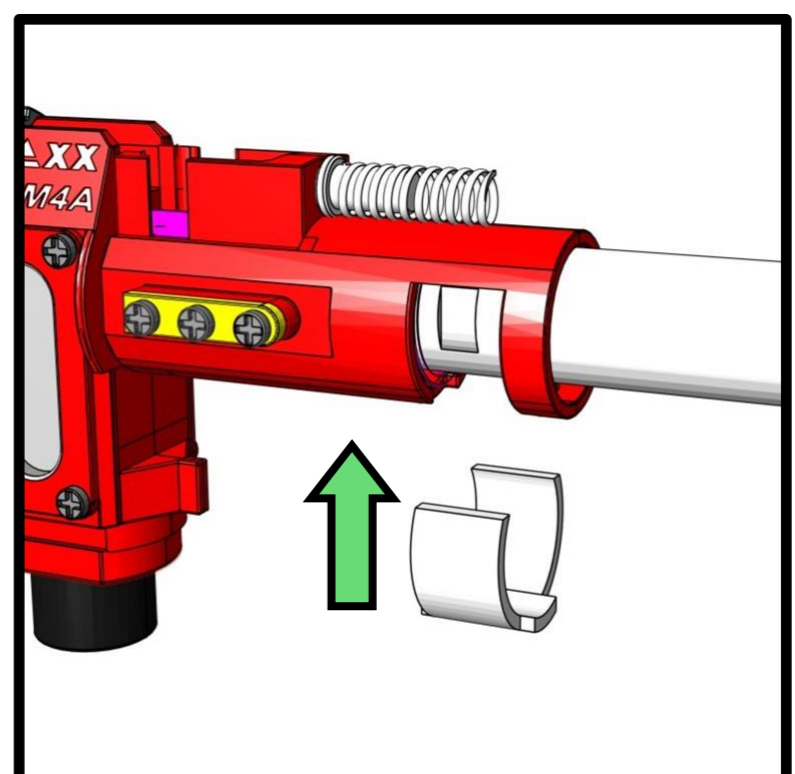

D5

D5. Take one of the M-nubs provided in the kit. And peel the 3m adhesive sticker off the top.

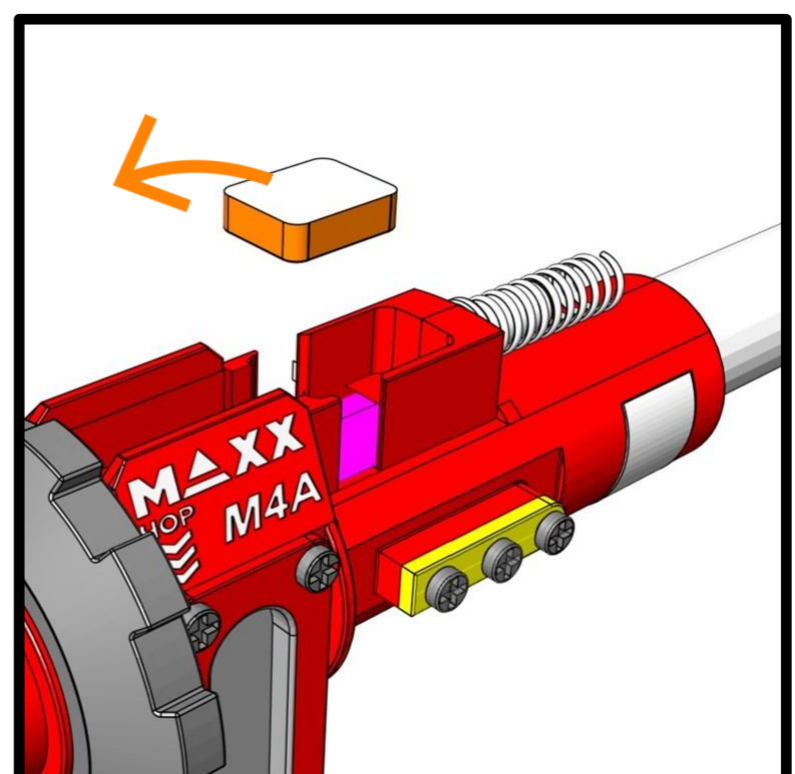

D06. Apply silicone grease all around the M-nub. Sides and bottom.

Do not apply on the adhesive top side.

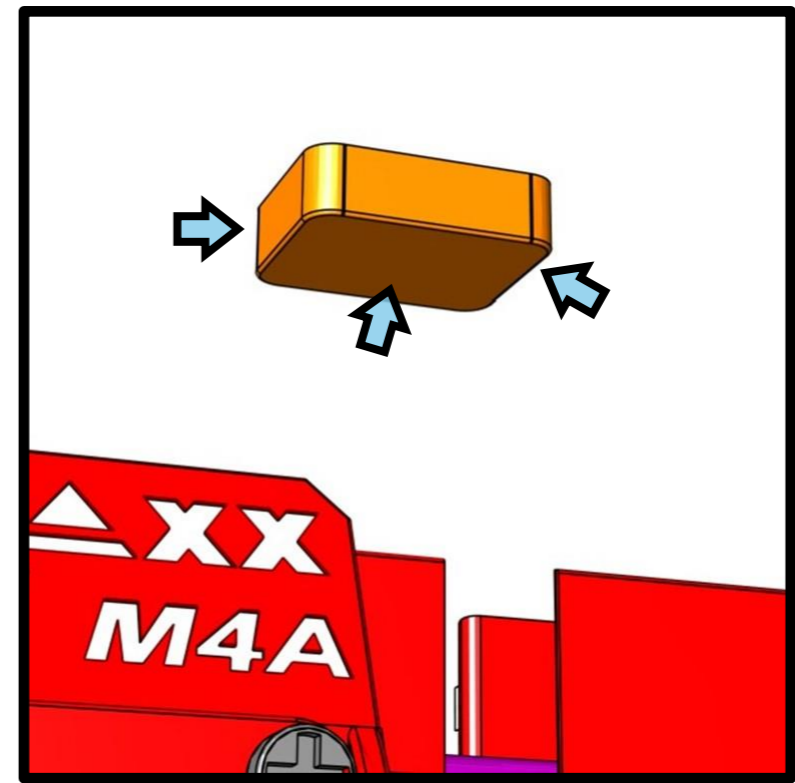

D06

D07. Place the M-nub into the hop-up window inside the chamber

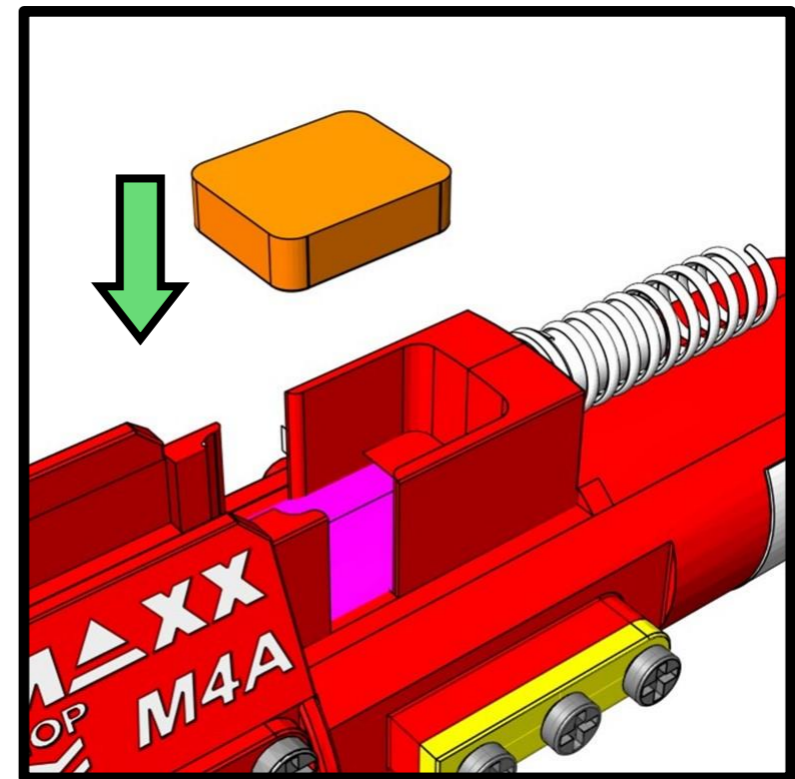

D07

D08. Align to ensure it cover the part of the bucking that is directly above the RHOP patch below.

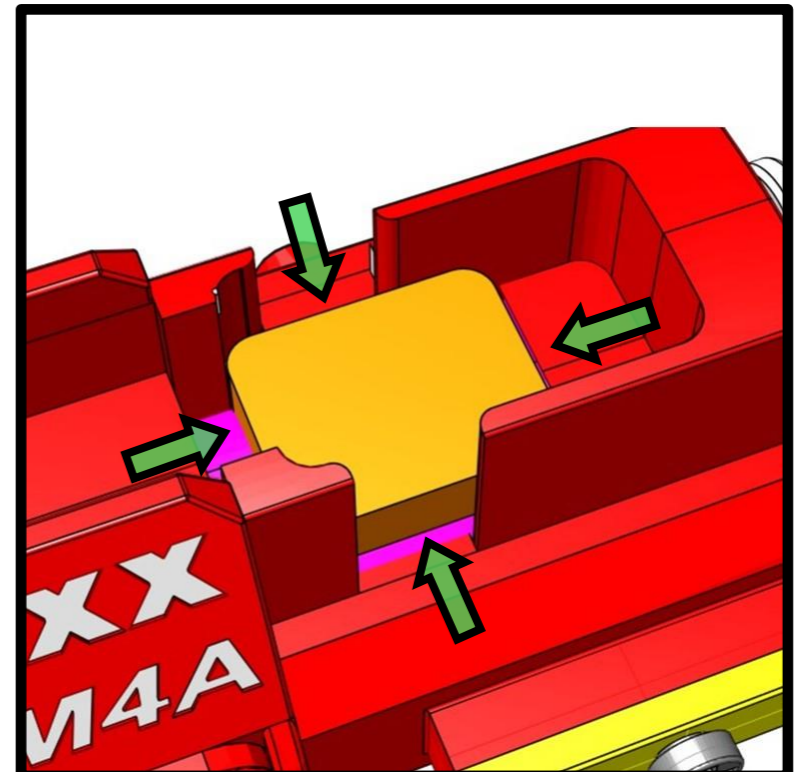

D08

D09. Place a dab of silicone grease at the underside of the TDC Trolley where the hole for the mini spring goes (Point A) this will help keep the small spring in place and easier to install. Next place the original mini Maxx spring to the underside.

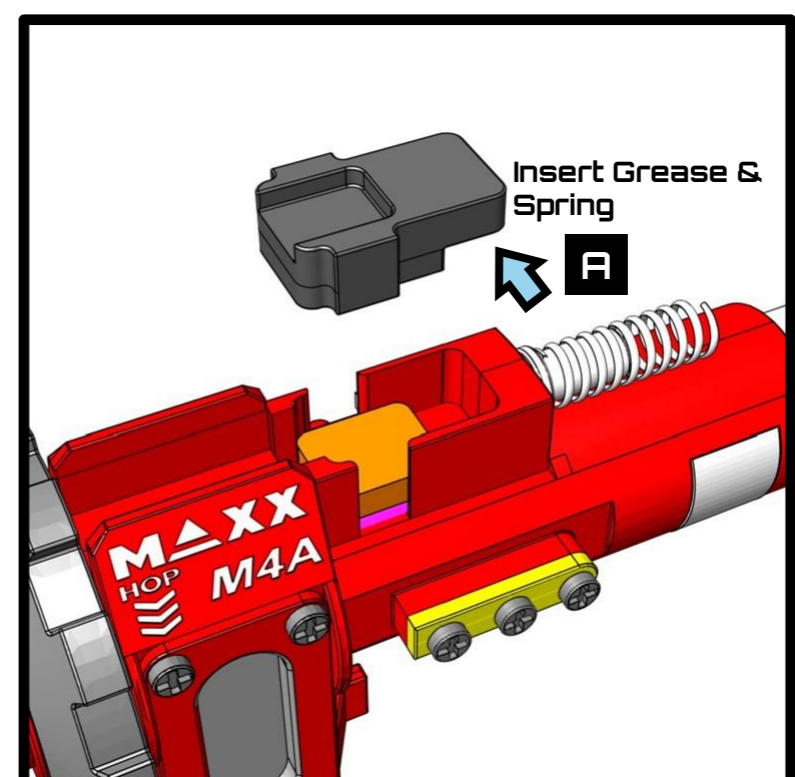

D09

D10. Install the TDC trolley and ensure the mini spring stays vertical also. Apply some grease on the sides where it needs to move up and down to make the operation smoother – this part is optional, but we recommend it.

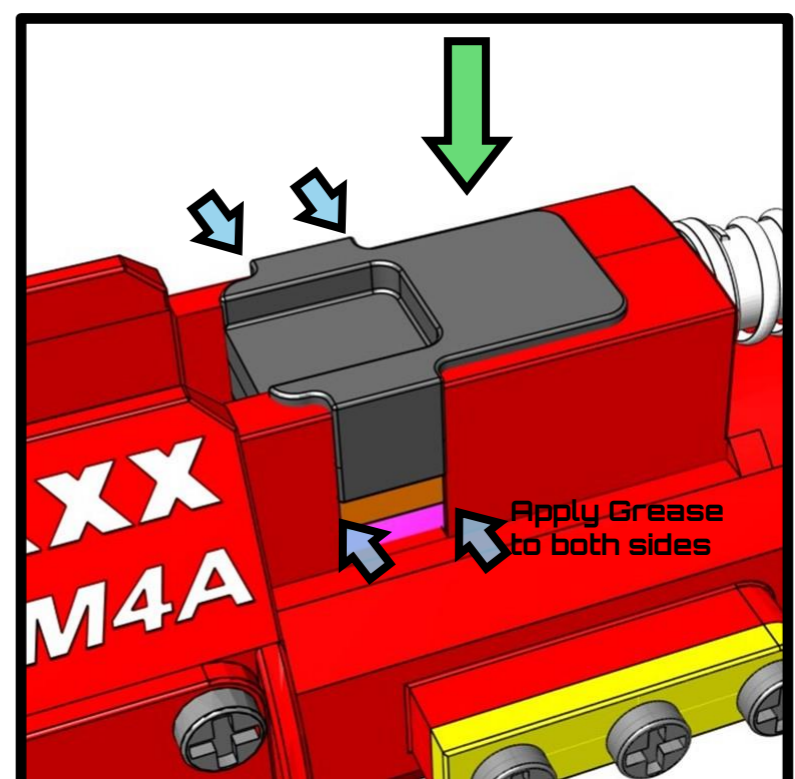

D10

D09. Install back the Original Maxx Adjustment Arm, pin and mini grub screw to complete the installation.

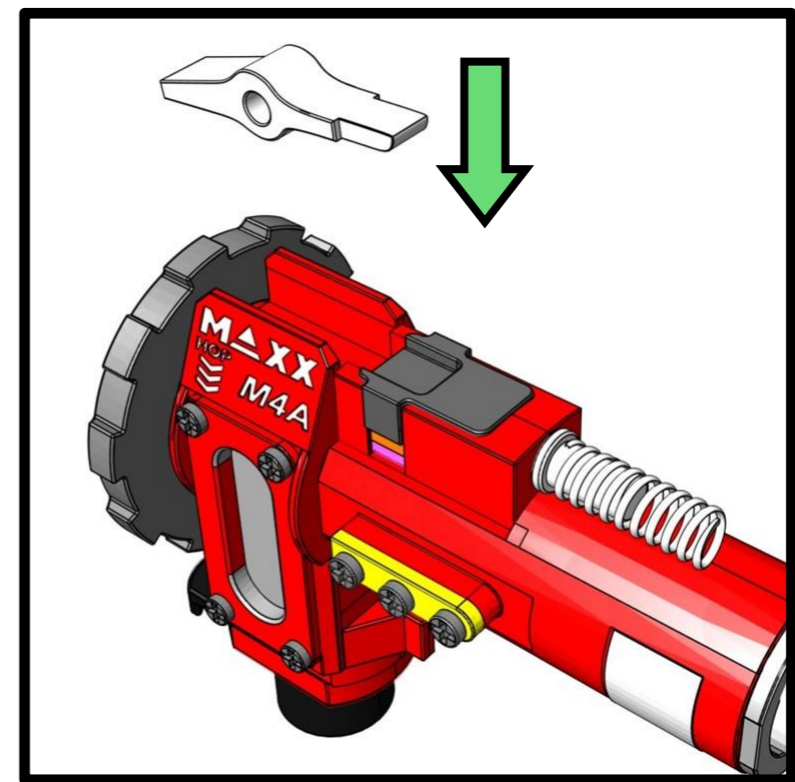

D11

D10. Ensure the dial is set to neutral zero hop position and peek inside the inner barrel to see that there's no mound.

If ok, twist the dial a few degrees and look into the inner barrel again and you should see a mound pushing down from above.

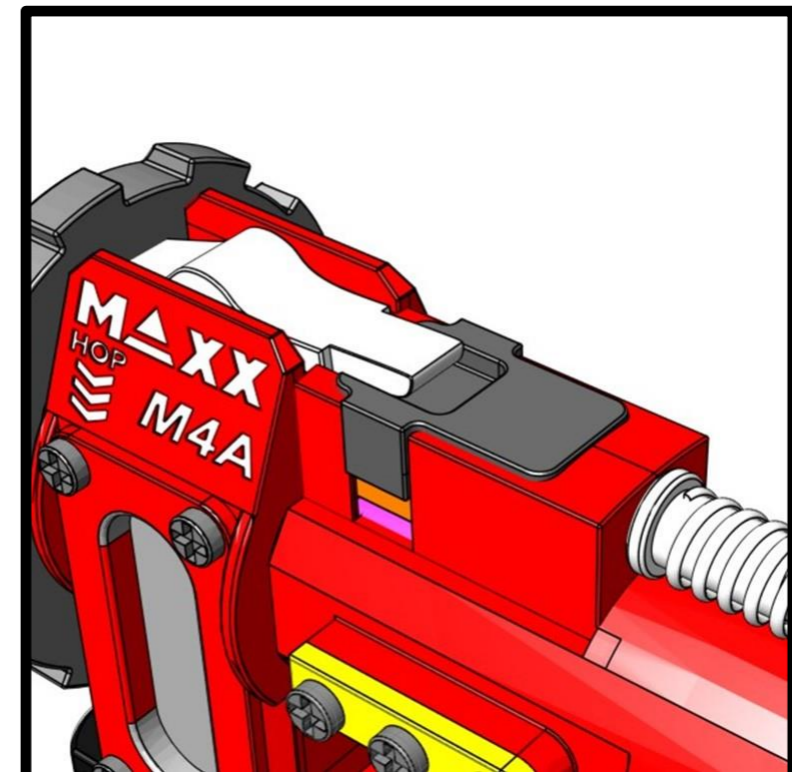

D12

Great job installing the Advanced TDC Trolley on your Maxx Model Chamber!

If you run into any issues during the setup process, please don't hesitate to reach out to our technical support team using the email provided. We're here to help you get your Maxx Model dialed in just right. Be sure to provide as much detail as possible about any problems you're facing, and we'll work with you to get everything sorted out.

Let me know if you have any other questions!
info@airtechstudios.com

Airtech Team